

UD-310
Rotary Die Cutter

SMART CHANGE STARTS HERE.

UD-310 ROTARY DIE CUTTER

The high-speed UD-310 Rotary Die Cutter delivers packaging and print marketing applications in distinctive shapes and sizes to help you stand out from the competition. Processing up to 4,000 sheets per hour, the UD-310 utilizes a magnetic cylinder and interchangeable flexible dies that affix to it to process paper, laminates, adhesives and synthetic stocks up to 400 gsm.

Offer custom finishing options by bringing this value-added service in-house. Suited for both long and shorter runs, the UD-310 is a highly productive and cost-efficient solution with minimal job setups and fast turnarounds.



Custom-made flexible dies

CUSTOMIZED FLEXIBLE DIES

Meet your customer's needs with flexible dies made according to their specifications. Economical and fast to manufacture flexible dies are made of engraved magnetic steel and offer a high degree of cutting accuracy compared to steel rule and solid dies. They are easy to mount, with alignment marks on the cylinder for quick adjustments, and can be switched out in less than a minute so you can get your jobs out the door faster.

Flexible dies can be designed to perform a range of finishing capabilities including die cutting intricate shapes, kiss-cutting labels and stickers, perforations with specified teeth, and three-knife creasing to prevent toner cracking on packaging applications.

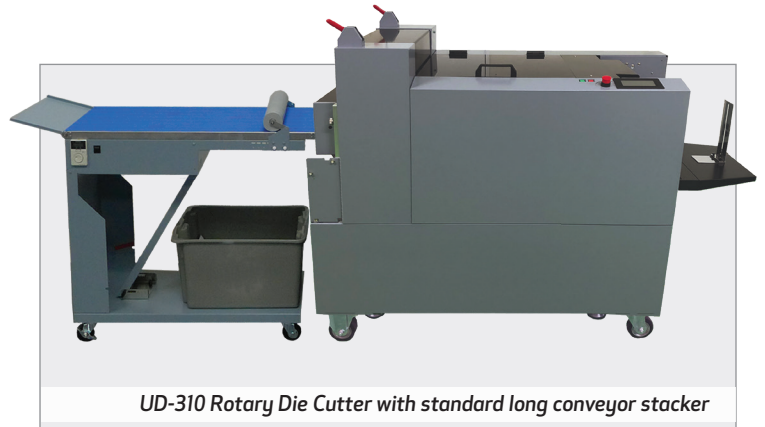

UD-310 Rotary Die Cutter with standard long conveyor stacker

APPLICATIONS



Packaging



Die-cut Business Cards



Stickers and Labels



Door Hangers and Hang Tags

PROFITABLE, VALUE- ADDED APPLICATIONS

The UD-310 brings value, opportunity, and profitability to the business of print. Produce business cards and brochures with decorative edges, retail packages with window punches, and unique product labels for impactful presentations. Offer event invitations, flyers, and direct mailers in precise shapes that help to boost response rates. Create a new revenue stream by producing boxes in-house such as sleeve, tuck end, gable, pillow, and so much more!



HIGH PRODUCTIVITY

Run an efficient and productive operation with simple setups and changeovers. Once the die is mounted over the magnetic cylinder and sheets are loaded on the feed tray, job setup is made through the intuitive touchscreen panel with individual buttons to start and stop operation.

Make adjustments in 0.1 mm increments along the width and length of the sheet to support proper sheet alignment with the fixed die position. Use the three-step speed adjustment to slow down or speed up the rotational speed of the cylinder for consistent cutting of thicker and thinner stocks.

Feeding up to 4,000 sheets per hour, the UD-310 features a high stack capacity of 8.7" (220 mm) and a ultrasonic double-feed sensor to detect when two or more sheets have been fed. The improved six-belt air suction feeder comes equipped with fans and air blowers to aid in the separation of double-sided laminated and synthetic stocks, as well as reduces the static on digitally-printed output.

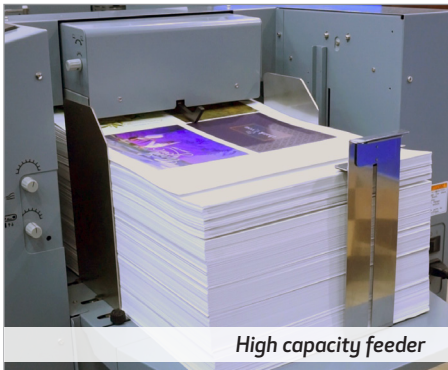

High capacity feeder



Long conveyor stacker

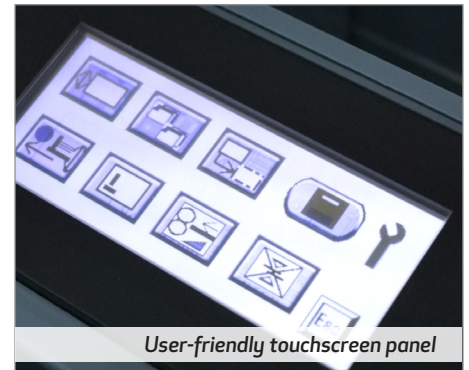

User-friendly touchscreen panel



ACCURATE FINISHING

With a registration mark printed on either side of the sheet, the UD-310 helps to ensure your jobs are finished with accuracy. The UD-310 utilizes X and Y registration sensors to read the mark and compensate for image shifting in both horizontal and vertical directions. Process sheets face up or down, depending on the application.

Registration guides adjust automatically and maintain sheet alignment throughout the job.



AUTOMATIC SEPARATION

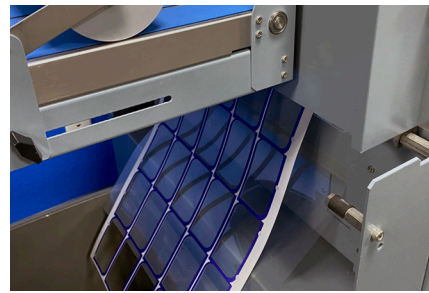

With die cutting, separation is key and the UD-310 comes built-in with a revamped separation station. It automatically removes the skeleton from

the finished pieces, deflecting it into the waste bin. The separation station utilizes a cassette module with deflectors and pressure rollers, and can be easily changed over to accommodate different types of jobs.

Only the finished pieces are delivered on the long conveyor stacker, which offers adjustable speeds to help ensure pieces are neatly stacked for quick removal.

SCAN TO WATCH THE VIDEO



- Produces custom-shaped jobs at high speeds and faster turnarounds
- Flexible dies designed to die cut, kiss cut, perforate, and three-knife crease
- Automatically separates skeleton from finished pieces
- Processes paper, laminates, adhesives, and synthetic stocks
- Future in-line capability with a digital press, UV coater, or high pile feeder



UD - 310 SPECIFICATIONS

Paper Size	Minimum: 8.267" x 11.693" (219 x 297 mm) Maximum: 15.35" x 20.47" (390 x 520 mm)
Paper Weight	Minimum: 106 gsm/ 28 lb. bond/ 6 point/ 0.0058"/ 0.15mm Maximum: 400 gsm/ 130 lb. cover/ 18 point/ 0.015"/ 0.4mm With Separator: Minimum 200 gsm
Speed	3-Step Speed Adjustment: High: 8,000 rotations - up to 4,000 sheets/hr Medium: 5,400 rotations - up to 2,700 sheets/hr Low: 2,700 rotations - up to 1,350 sheets/hr
Tolerance	±0.2 mm
Feed System	Air Suction, Top Belt Feeder
Feeder Capacity	Up to 8.7" (220 mm)
Substrates	Paper, laminates, adhesives, and synthetic stocks up to 400 gsm
Power	AC 110-115V 50/60 Hz. 5 Amps
Dimensions (L x W x H)	81.10" x 27.17" x 46.85" (2,060 mm x 690 mm x 1,190 mm) with conveyor: 127" x 27.17" x 46.85" (3,226 mm x 690 mm x 1,190 mm)
Weight	882 lbs. (400 kg)

Production rates are based on optimal conditions and may vary depending on stock and environmental conditions.